

FLOWZER Semi-Open Impeller Pump



Application:

Air-condition system, clean system, heating system;
Wine-brewing and food system;
household pressure boosting, industry liquid convey;
Convey weak corrosive liquid
Swimming pool system, drainage system, farmland irrigation system.

Feature:

Hydraulic bulge technology is adopted, sturdy construction;
Compact design;
Efficient spiral-cased pump body design;
The material of liquid parts is SUS304;
Mechanical shaft seal for security and tightness;
Multi-purpose, Transport a wide flange of liquid;
Connection mode: Thread, Clip, Hose connection

Performance Curves

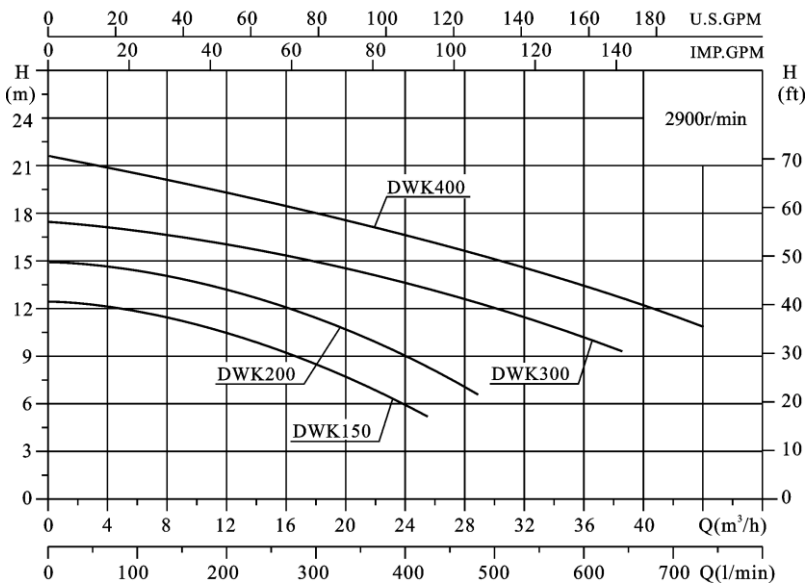

Technical Data:

2 pole asynchronous induction motor
Insulation class F
Protection class IP55
Single-phase: 220V/50Hz,
Three-phase: 230V/400V/50Hz
Single-phase motor built-in thermal protector
Liquid temperature: 5-90°C
Max. Operation pressure: 10 bar

Installation Structure

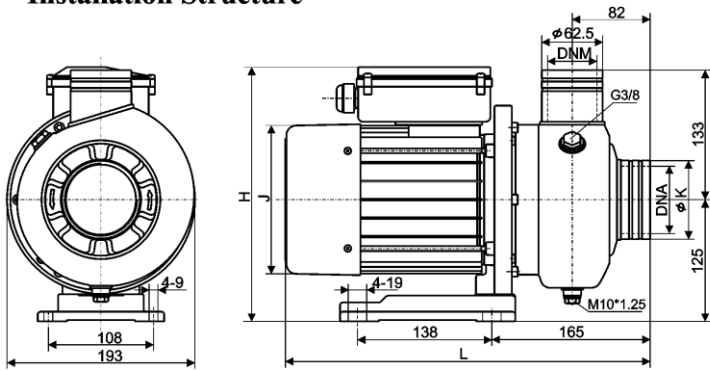

型号(MODEL)		H		K	DNA	DNM
单相 Single phase	三相 Three phase	单相 Single phase	三相 Three phase			
DWK150	DWK150T	155	378	265	235	62.5 G2 G2
DWK200	DWK200T	155	378	265	235	62.5 G2 G2
DWK300	DWK300T	169	415	242	242	80 G2½ G2
DWK400	DWK400T	169	432		242	80 G2½ G2

Model		Power (kW)	In x Out	Flow	L/min	0	100	200	300	400	500	600	700	800	900
220V	380V				m³/h	0	6	12	18	24	30	33	36	42	48
DWK150	DWK150T	1.1	2" x 2"	H (m)	12	11.5	10	7.5	5						
DWK200	DWK200T	1.5			15	14	13	10.5	9	6					
DWK300	DWK300T	2.2	2½" x 2"		17	16.5	16	15	13.5	11	10.5	10	9		
DWK400	DWK400T	3.0			21	20	19	17.5	16.5	15	14	13	12	11	